

PROPRIETARY AND CONFIDENTIAL
 THE INFORMATION CONTAINED IN THIS DRAWING IS THE SOLE PROPERTY OF ACCU-GLASS PRODUCTS INC. ANY REPRODUCTION IN PART OR AS WHOLE WITHOUT THE WRITTEN PERMISSION OF ACCU-GLASS PRODUCTS INC. IS **PROHIBITED.**

**HOLE NUMBER ASSIGNMENTS
 REAR VIEW**

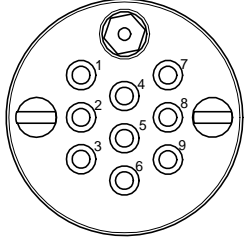

NUMBERS DO NOT APPEAR ON PART

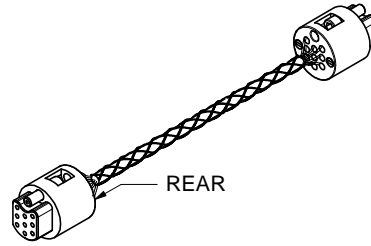

REAR

Rev	Description	Date	Approved
A	INITIAL RELEASE		

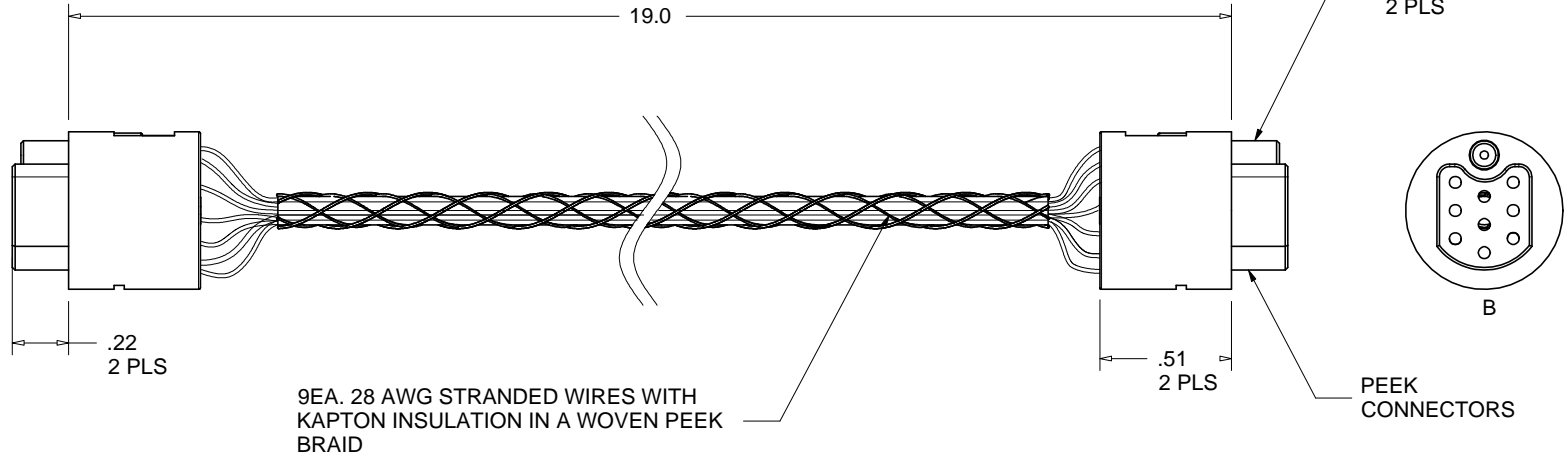
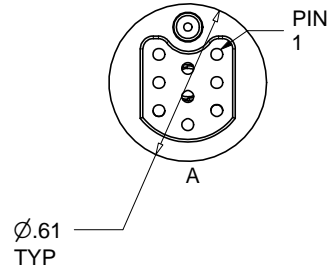

4-40 VENTED
 CAP SCREW
 STAINLESS
 2 PLS

PEEK
 CONNECTORS

9EA. 28 AWG STRANDED WIRES WITH
 KAPTON INSULATION IN A WOVEN PEEK
 BRAID



Accu-Glass Products Inc.
 25047 Anza Drive
 Valencia, CA 91355
 TEL 818-365-4215
 FAX 818-365-7074
 accuglassproducts.com

Notes:
 1. DIMENSIONS SYMMETRICAL ABOUT CENTERLINES

UNCONTROLLED WEB COPY

Material
 SEE ABOVE

Tolerances unless otherwise specified.

.X ± .03	Angular: +/- .5°
.XX ± .01	Finish: Min. 63 Ra
.XXX ± .005	

Title: **CKAP-C9-192SC**
KAPTON WIRE PEEK 9C BOTH ENDS 19LG

Drawn By Date	CR 102609	DWG. NO. 100120	Rev. A
Approved	C M	PDFE	Sheet 1 OF 1