

PROPRIETARY AND CONFIDENTIAL
 THE INFORMATION CONTAINED IN THIS DRAWING IS THE SOLE PROPERTY OF ACCU-GLASS PRODUCTS INC. ANY REPRODUCTION IN PART OR AS WHOLE WITHOUT THE WRITTEN PERMISSION OF ACCU-GLASS PRODUCTS INC. IS **PROHIBITED.**

HOLE LETTER ASSIGNMENTS
 REAR VIEW WITH
 STRAIN RELIEF REMOVED

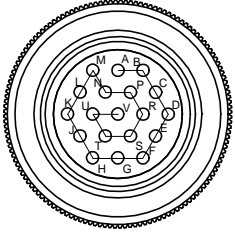

LETTERS MARKED ON PART
 AS SHOWN

ACCU-GLASS PRODUCTS, INC.
 TYPICAL WIRING

- A - YELLOW PAIR 1
- B - BLACK PAIR 1
- C - BROWN PAIR 2
- D - BLACK PAIR 2
- E - ORANGE PAIR 3
- F - BLACK PAIR 3
- G - RED PAIR 4
- H - WHITE PAIR 4
- J - RED PAIR 5
- K - BLACK PAIR 5
- L - BLUE PAIR 6
- M - BLACK PAIR 6
- N - GREEN PAIR 7
- P - BLACK PAIR 7
- R - RED PAIR 8
- S - BLUE PAIR 8
- T - WHITE PAIR 9
- U - BLACK PAIR 9
- V - GREEN PAIR 10
- RED PAIR 10

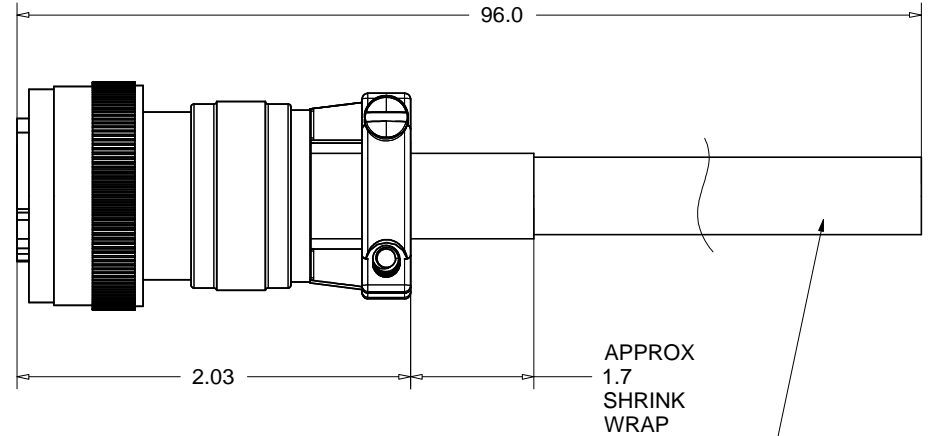
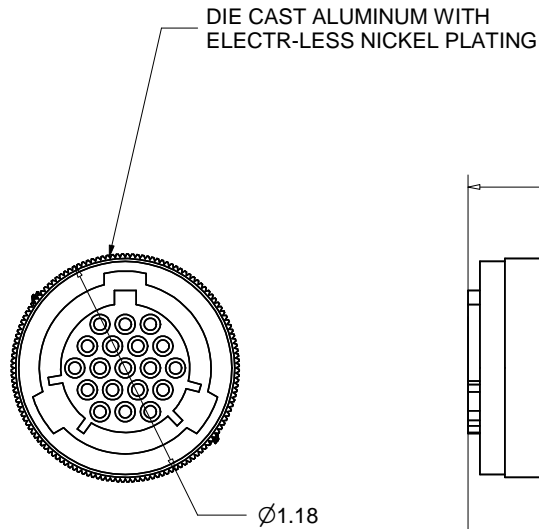
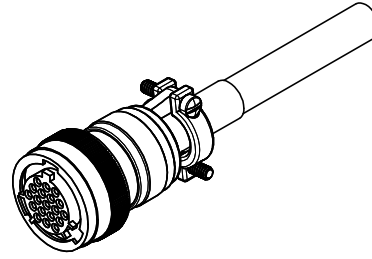

19 CONDUCTOR, 24 AWG, STRANDED AND TINNED, COPPER WIRE, WITH AN ALUMINUM-POLYESTER FOIL SHIELD WRAP IN A GREY PVC JACKET

Rev	Description	Date	Approved
A	INITIAL RELEASE		

RELATED PRODUCTS, AIR CP19
P/N 110235, CONTACT, FEMALE, TYPE-T5i 20-24AWG
P/N 110702, CRIMP TOOL, FOR TYPE-T5i CONTACTS
P/N 111612, EXTRACTION TOOL, FOR TYPE-T5i CONTACTS
P/N 111611, INSERTION TOOL, FOR TYPE-T5i CONTACTS



Accu-Glass Products Inc.
 25047 Anza Drive
 Valencia, CA 91355
 TEL 818-365-4215
 FAX 818-365-7074
 accuglassproducts.com

Notes:
 1. DIMENSIONS SYMMETRICAL ABOUT CENTERLINES

UNCONTROLLED WEB COPY

Material ASSEMBLY	
Tolerances unless otherwise specified.	
.X ± .03	Angular: +/- .5°
.XX ± .01	Finish: Min. 63 Ra
.XXX ± .005	

Title: AIR-CP19-96SC			
19C AIR SIDE FEMALE CONNECTOR AND CABLE 96" OAL			
Drawn By Date	CR 081809	DWG. NO. 110233	Rev. A
Approved	CM	PDFE	Sheet 1 OF 1