

PROPRIETARY AND CONFIDENTIAL
THE INFORMATION CONTAINED IN THIS
DRAWING IS THE SOLE PROPERTY OF
ACCU-GLASS PRODUCTS INC. ANY
REPRODUCTION IN PART OR AS WHOLE
WITHOUT THE WRITTEN PERMISSION OF
ACCU-GLASS PRODUCTS INC.IS
PROHIBITED.

HOLE NUMBER ASSIGNMENTS
FRONT VIEW

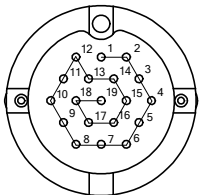

NUMBERS DO NOT APPEAR
ON PART

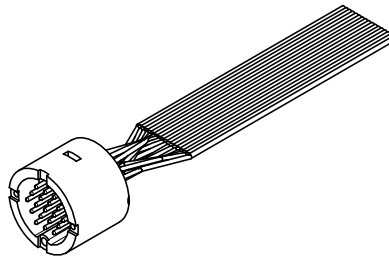

4-40 UNC
TAPPED

Ø.98

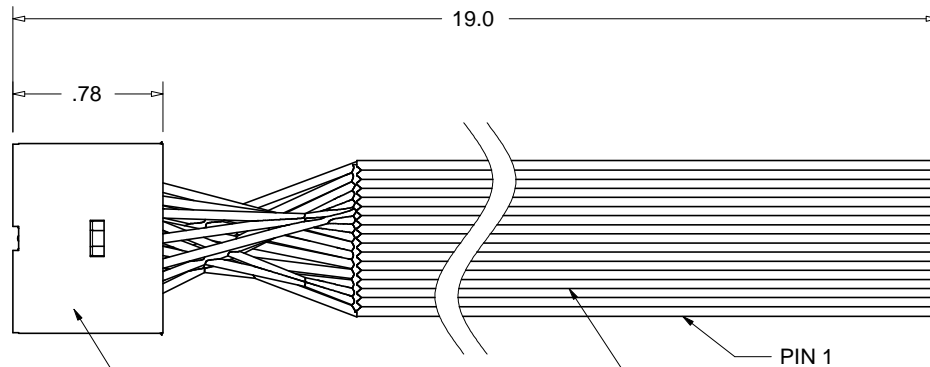
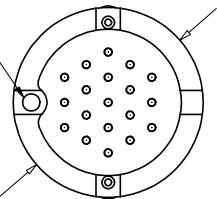

PEEK 19C, 19 PIN
MALE CONNECTOR
ASSEMBLY PER
MIL-C-26482

19 CONDUCTOR, KAPTON
INSULATED RIBBON CABLE
28 AWG SILVER PLATED COPPER
STRANDED WIRE

PIN 1



Accu-Glass Products Inc.
25047 Anza Drive
Valencia, CA 91355
TEL 818-365-4215
FAX 818-365-7074
accuglassproducts.com

Notes:
1. DIMINSIONS SYMMETRICAL ABOUT CENTERLINES

UNCONTROLLED WEB COPY

Material
assembly

Tolerances unless otherwise
specified.

.X ± .03

.XX ± .01

.XXX ± .005

Angular:
+/- .5°
Finish:
Min. 63 Ra

Title: **KAP-R19-19PC**
19C PEEK MALE KAPTON RIBBON 19"LG

Drawn By
Date

CR
2/4/2010

DWG.
NO. **110812**

Rev. **A**

Approved

C M

PDFE

Sheet 1 OF 1