

Notes

- 1. Leak test to 5x10E-10 Standard cc/sec of He
- 2. Protect seal surfaces (knife-edge) from damage.
- 3. Standard hinge is adjusted for 195-degree swing-angle
- 4. Install door-stop kit No. 112980 if 120-degree hinge swing-angle is desired (sold separately).
- 5. This door is fitted with a 7056 Borosilicate window / viewport

Rev	Description	Date
A	Initial Release	

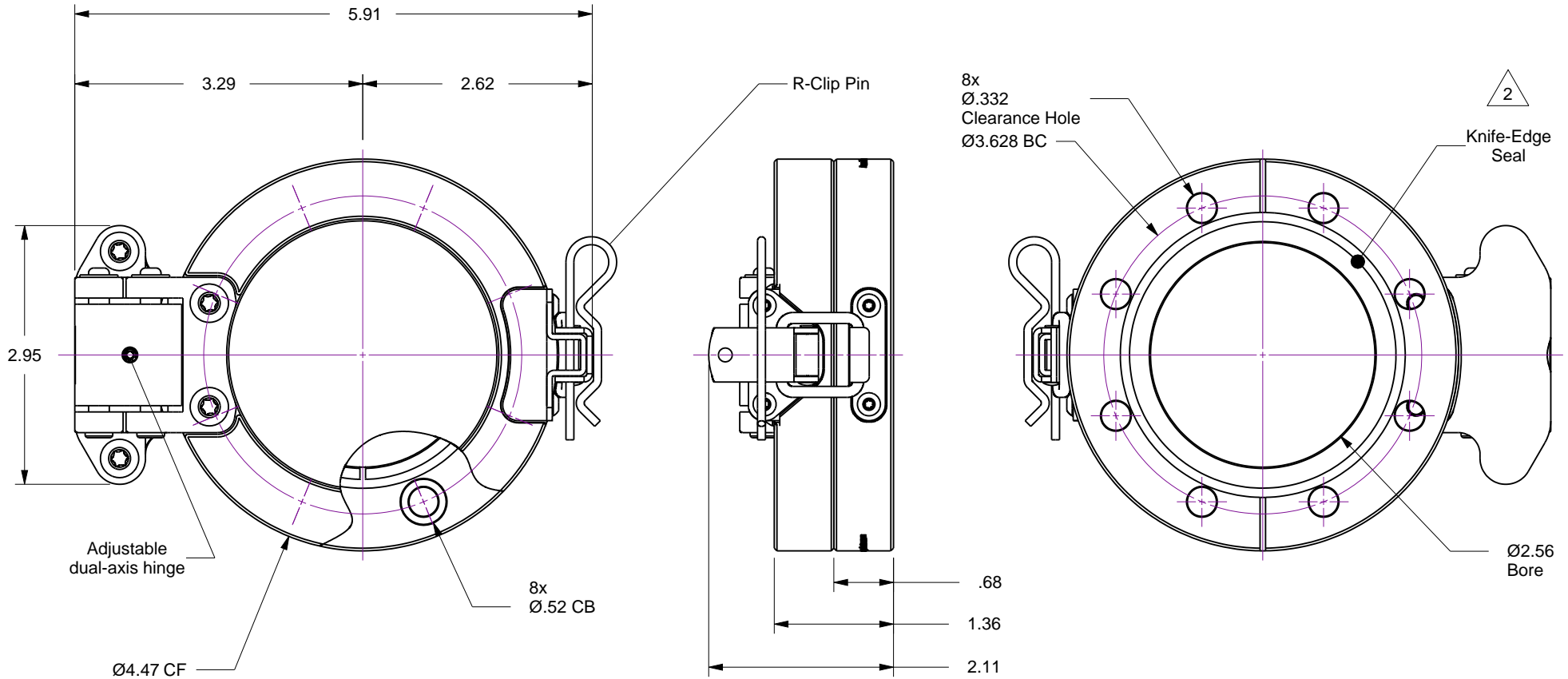

Accu-Glass Products Inc.
 25047 Anza Drive
 Valencia, CA 91355
 T 818-365-4215
 F 818-365-7074
 www.accuglassproducts.com

UNCONTROLLED WEB DRAWING

Proprietary and Confidential
 The information contained in this drawing is the sole property of Accu-Glass, Products Inc. Any reproduction, in part or as whole, without the written permission of Accu-Glass Products, Inc., is strictly prohibited.

Material See Individual Components	
Tolerances, unless otherwise specified	
.X ± .030	Angles ± 0.5° Finish 63Ra
.XX ± .010	
.XXX ± .005	

Title Access Door, 4.50 CF Viewport w/Clearance Holes			
Drawn by Date	Ligeti 8/31/2015	No. 112945	Rev. A
Approved			Sheet