

Notes

1. UHV compatible 'Normally Closed' Limit Switch, AGP Model No. SWITCH-UHV-NC
2. This switch is designed for plate or bracket mounting inside a UHV chamber, which requires a .375 inch clearance, or .375-24 UNF threaded hole for installation. Note that the maximum bracket or plate thickness this switch will accommodate is 5/8 of an inch. The two stainless steel nuts (supplied) are used to securely lock the switch assembly in place.
3. Custom solutions are available on request

Rev	Description	Date
A	Initial Release	

Material List	
Description	Material
Body	PEEK
Internal Contacts	Gold Plated Beryllium Copper
Nuts	Stainless Steel

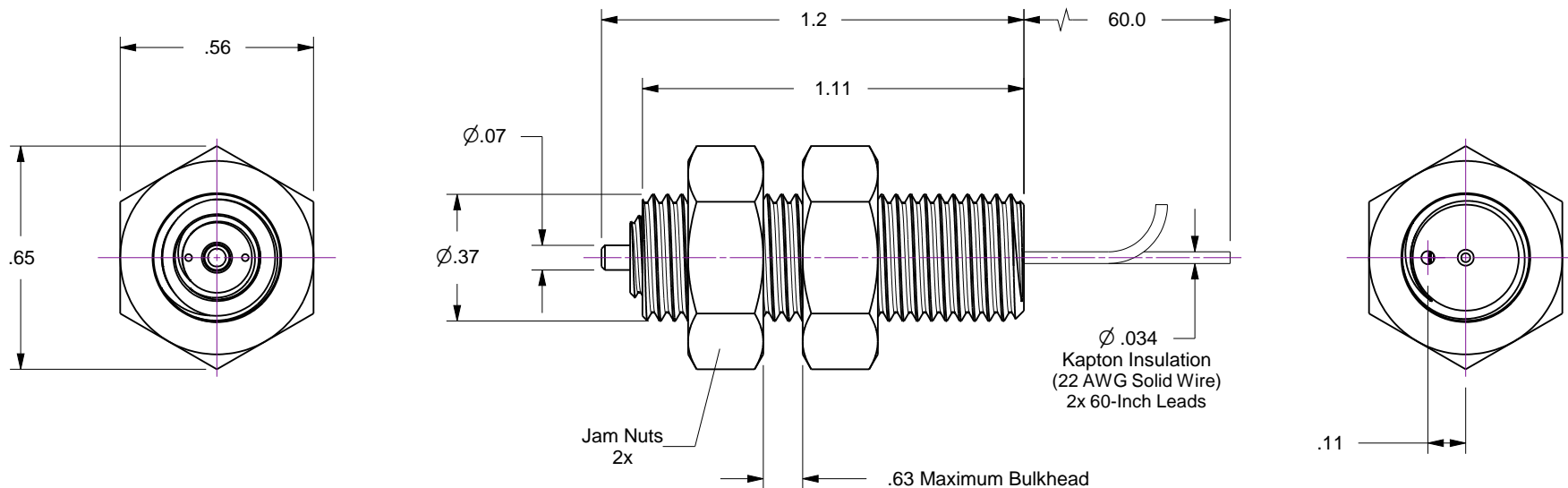
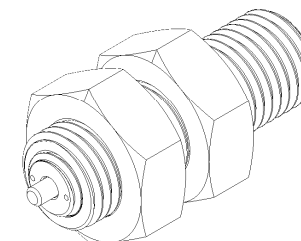

Accu-Glass Products Inc.
 25047 Anza Drive
 Valencia, CA 91355
 T 818-365-4215
 F 818-365-7074
 www.accuglassproducts.com

UNCONTROLLED WEB DRAWING

Proprietary and Confidential
 The information contained in this drawing is the sole property of Accu-Glass, Products Inc. Any reproduction, in part or as whole, without the written permission of Accu-Glass Products, Inc., is strictly prohibited.

Material See Individual Components	
Tolerances, unless otherwise specified	
.X ± .030	Angles ± 0.5°
.XX ± .010	Finish 63Ra
.XXX ± .005	

Title Switch-UHV			
Drawn by Farrell	Date 9/2/2015	No. 113170	Rev. A
Approved			Sheet